

MT-3405TM_{LR F}

5 - BOOM AUTOMATIC RATE CONTROL



The MT-3405_{LR F}, Micro-Trak's newest addition to the MT-3400 family, features 5-boom control in a sleek and rugged, extruded aluminum console.

This next generation electronic rate controller displays all the necessary information for accurate application of liquids and anhydrous (regardless of changing field conditions or vehicle speed), in addition to positive control at a predetermined rate.

The MT-3405 allows you to monitor up to eight different functions, plus two area counters with independent resets. The delta feature allows the operator to change application rates on-the-go in automatic operation, without stopping to recalibrate the unit.

The MT-3405 comes complete with console, 3/4" flowmeter, 1" servo valve, hall effect speed and flow sensor and weatherproof connectors. A new feature to the MT-3405 is the ability to control either solenoid or motorized ball valves with one console.

The MT-3405 is not only capable of operating the standard Micro-Trak servo valve, but can also operate other 12-volt servo valves such as Braglia and Arag.

MEASUREMENT CAPABILITIES

The MT-3405 provides the ability to monitor, measure and store key information for verification of correct application and an accurate record of work performed.

Application Rate – Measures the amount of liquid applied per unit of area

Flow Rate – Measures the amount of liquid applied per minute

Total Flow – Records the total amount of liquid applied

Total Area – Maintains a running total of all work performed

Sub Area – Provides a separate measure of individual fields or jobs

Area Per Hour – Tracks work progress

Ground Speed

Linear Distance Travelled

Measurements are registered with a one-tenth of a unit accuracy and can be displayed in either English or Metric.

Total flow, distance and area counters can be independently reset without affecting other stored totals.

SYSTEM FEATURES

- Exclusive BriteKnob™, panel lighting and illuminated readout for night use
- Heavy-duty toggle switches for power, run/hold and independent control of up to five boom sections
- High contrast Liquid Crystal Display with large, easy-to-read numbers and boom status indicators
- Durable Hall-effect (non-mechanical) speed and flowmeter sensors
- Heavy-duty, weather resistant console and weatherproof cable connectors
- Out-of-range warning light



Manufactured in the U.S.A. by:

MICRO-TRAK[®]
SYSTEMS, INC.
An Electronics Company

MT-3405TM LRF AUTOMATIC RATE CONTROL

The standard system includes: MT-3405 console, mounting bracket and hardware, cabling, 3/4" flowmeter, 1" servo valve and Hall-effect speed and flow sensors.

The diagram below shows the MT-3405 incorporated into a typical spraying system. Shown here with solenoid valves and bypass lines, this system gives quicker response and enables the MT-3405 to provide pressure relief/bypass when the master switch is in hold. (Also works with motorized ball valves.)

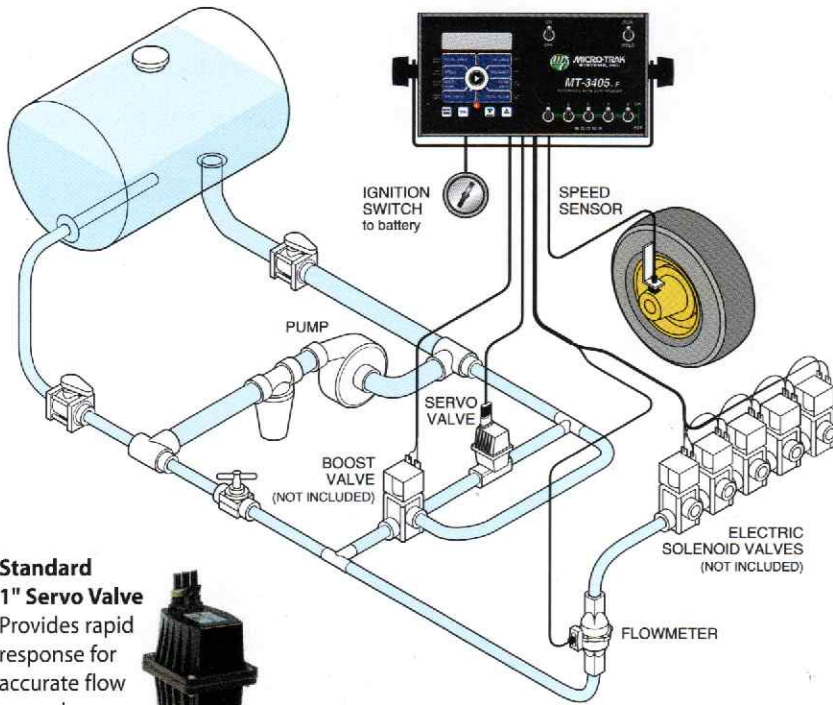

Standard 1" Servo Valve
Provides rapid response for accurate flow control



Flowmeter:
Choose either 3/4" stainless steel or the 3/4" glass-filled nylon. See specifications at right.

CUSTOMER SATISFACTION AND SUPPORT

Micro-Trak products carry a guarantee of satisfaction and are warranted against defects in materials or workmanship. Details of these policies are included with each product.

Micro-Trak also provides technical support that is among the best in the industry to answer your troubleshooting questions and concerns.

For the name of your nearest Micro-Trak dealer or distributor, call:

TOLL-FREE U.S. AND CANADA 1-800-328-9613



Manufactured in the U.S.A. by:
MICRO-TRAK[®]
SYSTEMS, INC.
An Electronics Company

111 East LeRay Avenue / P.O. Box 99 / Eagle Lake, MN 56024-0099

Phone: (507) 257-3600 / Fax: (507) 257-3001

Web site: www.micro-trak.com / E-mail: trakmail@micro-trak.com

OPTIONAL EQUIPMENT

Flowmeters

1/2" FM500

Flow range: .5-5 GPM (2-20 l/min)
Max Pressure: 500 PSI (34 Bar)
Pressure Drop: 1 PSI @ 5 GPM



3/4" FM750 GFN

Flow range: 2-40 GPM (7.5-150 l/min)
Max Pressure: 100 PSI (10 Bar)
Pressure Drop: 1 PSI @19 GPM



3/4" FM750 SS

Flow range: 2-40 GPM (7.5-150 l/min)
Max Pressure: 500 PSI (34 Bar)
Pressure Drop: 1 PSI @ 20 GPM
(4 PSI @ 40 GPM)



1" FM1000 SS

Flow range: 3.5-70 GPM
(13-265 l/min)
Max Pressure: 500 PSI (34 Bar)
Pressure Drop: 1 PSI @ 30 GPM
(6 PSI @ 70 GPM)



1 1/2" FM1500 SS

Flow range: 10-130 GPM
(38-492 l/min)
Max Pressure: 500 PSI (34 Bar)
Pressure Drop: 1 PSI @ 35 GPM
(10 PSI @ 110 GPM)



■ **NH3500 Kit** – Micro-Trak's premium performance NH₃ control. Requires no manual adjustment; application settings and the system's on/off status are all controlled from your sprayer control console, in the safety of your cab.

■ **Equalizer Kit** – a full-range, high capacity automatic control system. Low resistance and high efficiency allow for exceptional performance even at extremely low temperatures.



Continental Equalizer[™]

Up to 9000 lbs. NH₃/hr.



NH3500

600 to 6000 lbs. NH₃/hr.

■ **Control Kit for Raven Super Cooler** –

A full range, high capacity plumbing control kit for use with the Raven Super Cooler. Pre-assembled and tested with low resistance and high efficiency.

